

StoGuard® Waterproof Air Barrier Frame Construction

Continuous Insulation - Brick Cavity or Other Cladding

Detail No.: 20.00e

Date: March 2014

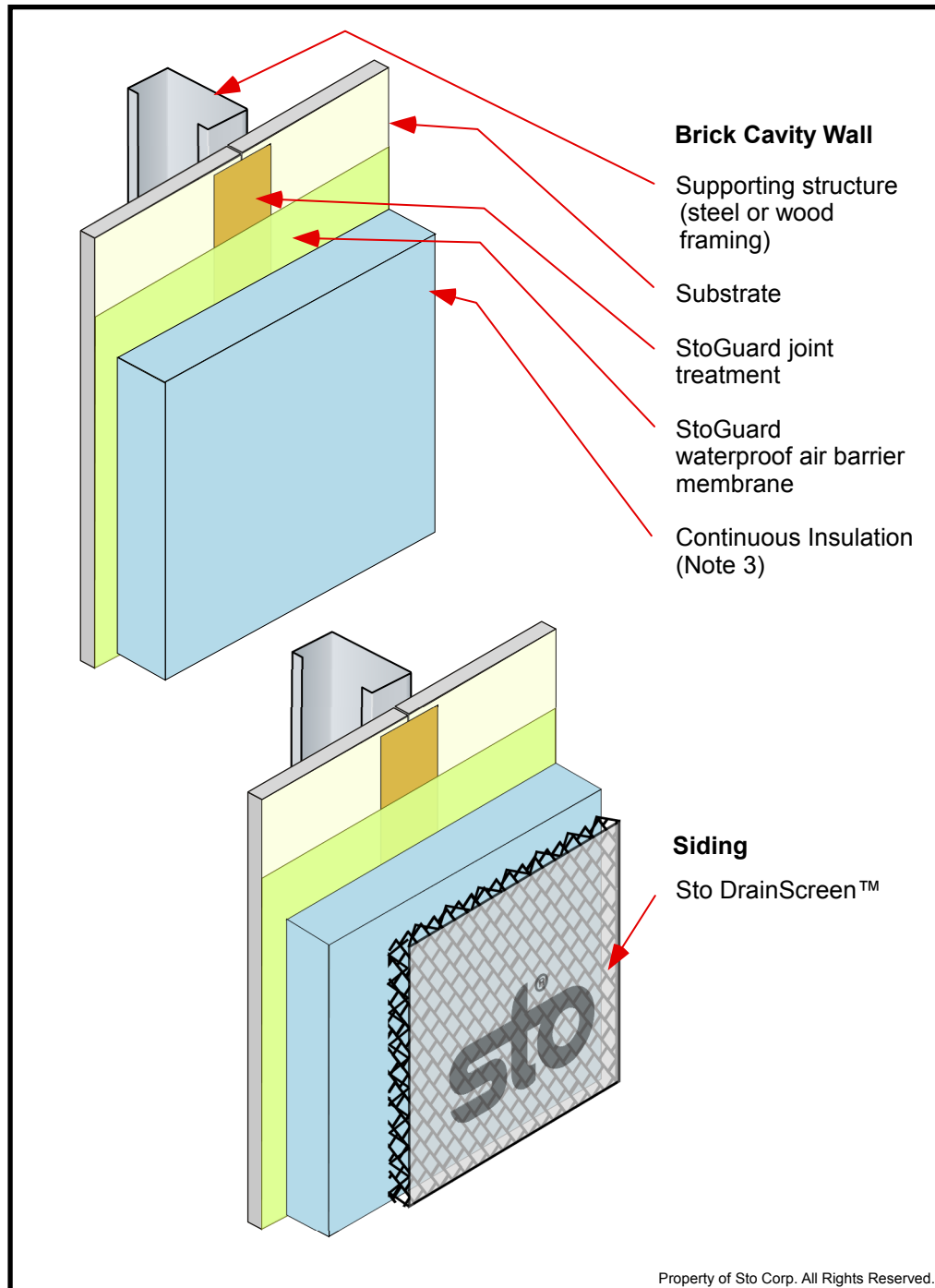

Notes:

- 1] StoGuard joint treatment options:
 - A) StoGuard RapidFill
 - B) Sto Gold Fill® with StoGuard Mesh joints $\leq 1/8"$ (3 mm) wide
 - C) StoGuard Fabric with StoGuard waterproof air barrier membrane joints $\leq 1/8"$ (3 mm) wide
 - D) StoGuard RapidSeal™ with StoGuard Mesh - joints $\leq 1/4"$ (6 mm) wide
- 2] StoGuard waterproof air barrier membrane options:
 - A) Sto EmeraldCoat®
 - B) StoGuard VaporSeal™
 - C) Sto AirSeal™
 - D) Sto Gold Coat®

(Use with StoTherm NExT EIF systems)
- 3] Continuous foam plastic insulation must be approved and in conformance with IRC Section 316 and IBC Section 2603 (note required fire tests for use on noncombustible construction). Consult with cladding manufacturer for required supports, attachment and limitations for assemblies involving continuous insulation.
- 4] Refer to Sto specifications and product bulletins for detailed information on substrates and Sto material options.

IMPORTANT: Components not identified as Sto are furnished by other manufacturers and are not necessarily installed by trades who install the Sto products. Refer to project specific contract documents.

Attention

Sto products are intended for use by qualified professional contractors, not consumers, as a component of a larger construction assembly as specified by a qualified design professional, general contractor or builder. They should be installed in accordance with those specifications and Sto's instructions. Sto Corp. disclaims all, and assumes no, liability for on-site inspections, for its products applied improperly, or by unqualified persons or entities, or as part of an improperly designed or constructed building, for the nonperformance of adjacent building components or assemblies, or for other construction activities beyond Sto's control. Improper use of Sto products or use as part of an improperly designed or constructed larger assembly or building may result in serious damage to Sto products, and to the structure of the building or its components. **STO CORP. DISCLAIMS ALL WARRANTIES EXPRESS OR IMPLIED EXCEPT FOR EXPLICIT LIMITED WRITTEN WARRANTIES ISSUED TO AND ACCEPTED BY BUILDING OWNERS IN ACCORDANCE WITH STO'S WARRANTY PROGRAMS WHICH ARE SUBJECT TO CHANGE FROM TIME TO TIME.** For the fullest, most current information on proper application, clean-up, mixing and other specifications and warranties, cautions and disclaimers, please refer to the Sto Corp. website, www.stocorp.com.

www.stocorp.com